

Key and estimated environmental contribution of removed trees

#	species	Dbh*	Ht+	swi	Kwh	Co2
1	Willow Oak	21	30	5,657	148	744
2	Willow Oak	27	55	9,165	216	1,013
3	Oak	34	60	14,151	291	1,236
4	Willow Oak	35.5	65	15,334	311	1,271
5	Willow Oak	31	65	11,964	257	1,146
6	Locust	10	25	1,586	72	398
7	Locust	8.3	25	1,194	58	285
8	Locust	9	30	1,328	64	318
9	Locust	8.6	25	1,251	60	299
10	Locust	9	30	1,328	64	318
11	Locust	8.9	30	1,308	63	313
12	Locust	10	30	1,586	72	398
13	Locust	8.6	25	1,251	60	299
14	Locust	7.6	20	1,060	52	252
15	Locust	7.6	20	1,060	52	252
16	Locust	5.4	15	640	34	148
17	Oak	43	70	21,434	402	1,349
18	Locust	38.5	45	7,261	188	158
19	Locust	5.7	12	697	36	162
20	Ginko	13.4	25	2,464	100	672
21	Ginko	12.4	25	2,206	92	591
22	Ginko	11	25	1,844	80	479
23	Ginko	12.7	25	2,283	94	616
24	Ginko	14.6	30	2,774	110	768
25	Mulberry	12.7	30	2,283	94	616
26	Pin Oak	17	20	3,837	114	578
27	Pin Oak	18.8	55	4,656	130	653
28	Oak	33.4	50	13,678	283	1,221
29	Pin Oak	41	65	19,764	380	1,352
30	Pin Oak	17	35	3,837	114	578
total		532.7		158,881	4091	18,483

*dbh – diameter at breast height measured in inches
 +Ht – height measured in feet
 swi – Stormwater intercepted per year in gallons
 kwh – kilowatt hours of electricity for cooling conserved per year
 Co2 – reduced atmospheric carbon in pounds/year
 specimen trees

Trees Removed from the Fire Station Site at 800 York Road 4/1/2017

Total trees removed: 30

“Specimen trees” removed: 7 (Specimen trees have a diameter of 30 inches or more. Under the Forest Conservation Act of Maryland, developers are required to prove they were being denied reasonable and significant use of the property and obtain a variance to remove them.

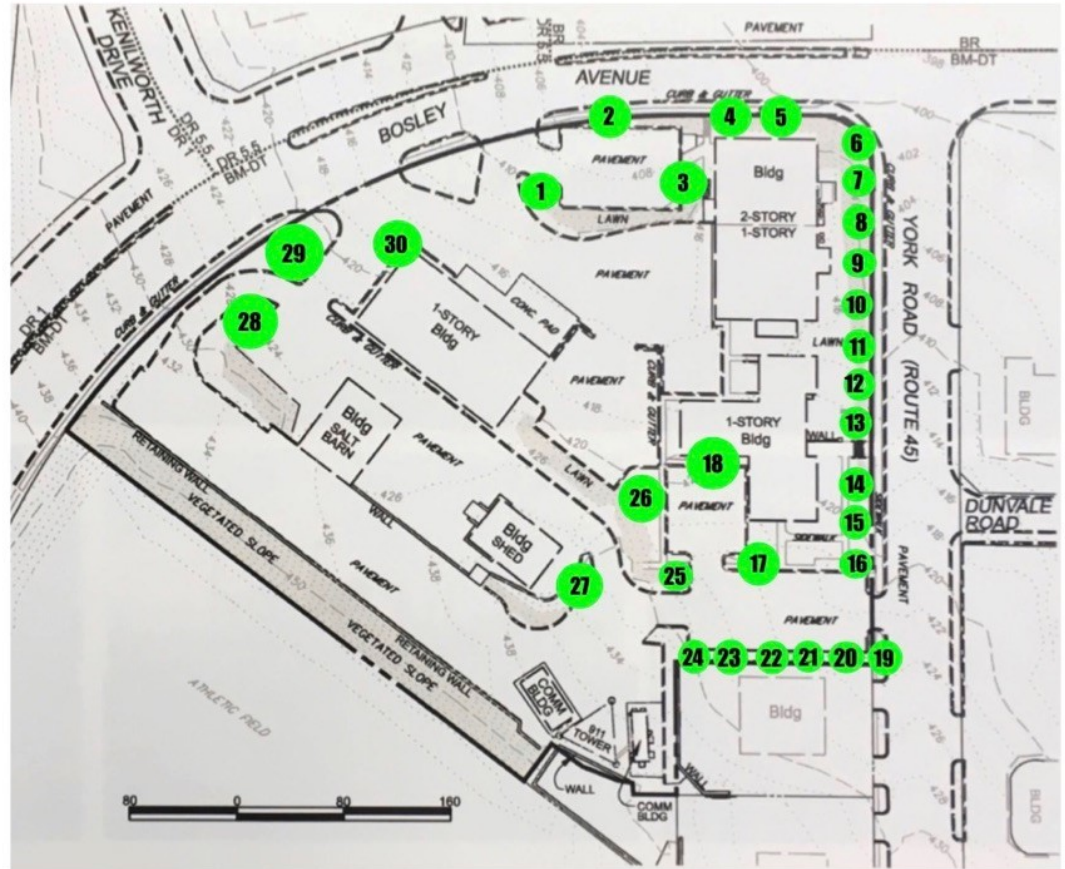

Prepared by the Green Towson Alliance 4/2/2017
 using the National tree Benefit Calculator developed by Casey Trees and Davey Tree Expert Co.
 Data on tree dbh and height was taken from a survey conducted in the Fall of 2016